

Magnetic Slide Potentiometers

Types of Magnetic Slide pots:

- 8mm Slide Sensor
- 45mm Thin Slide Sensor
- 45mm Slide Sensor

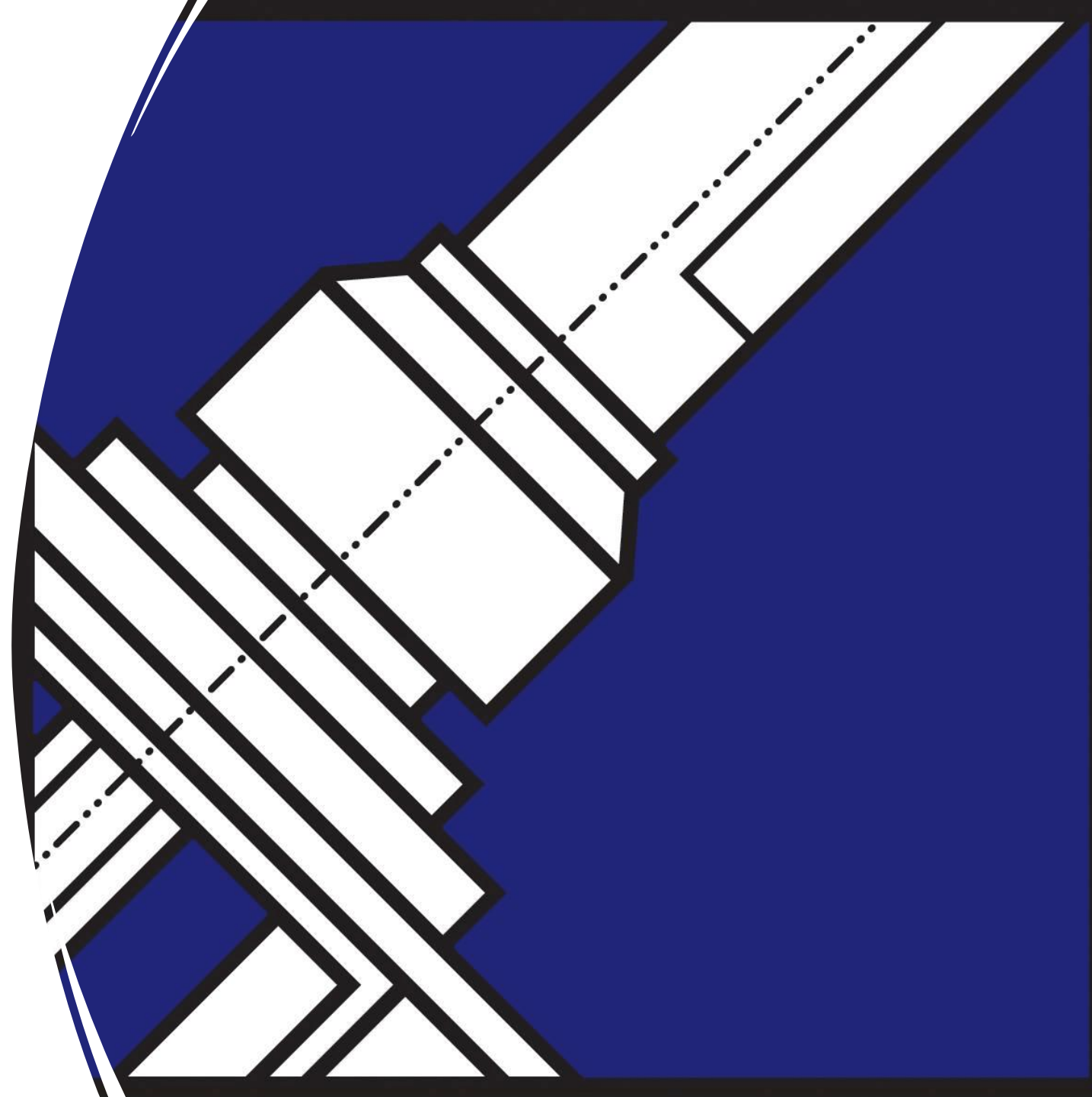

SLIDE SENSOR

8 mm Slide Sensor



◆ FEATURE

- High-precision linearity,
- Space saving design contribute to lighter weight and smaller size of the set.

◆ APPLICATIONS

- Exclusive for head light angle detection with accuracy and space-saving design.

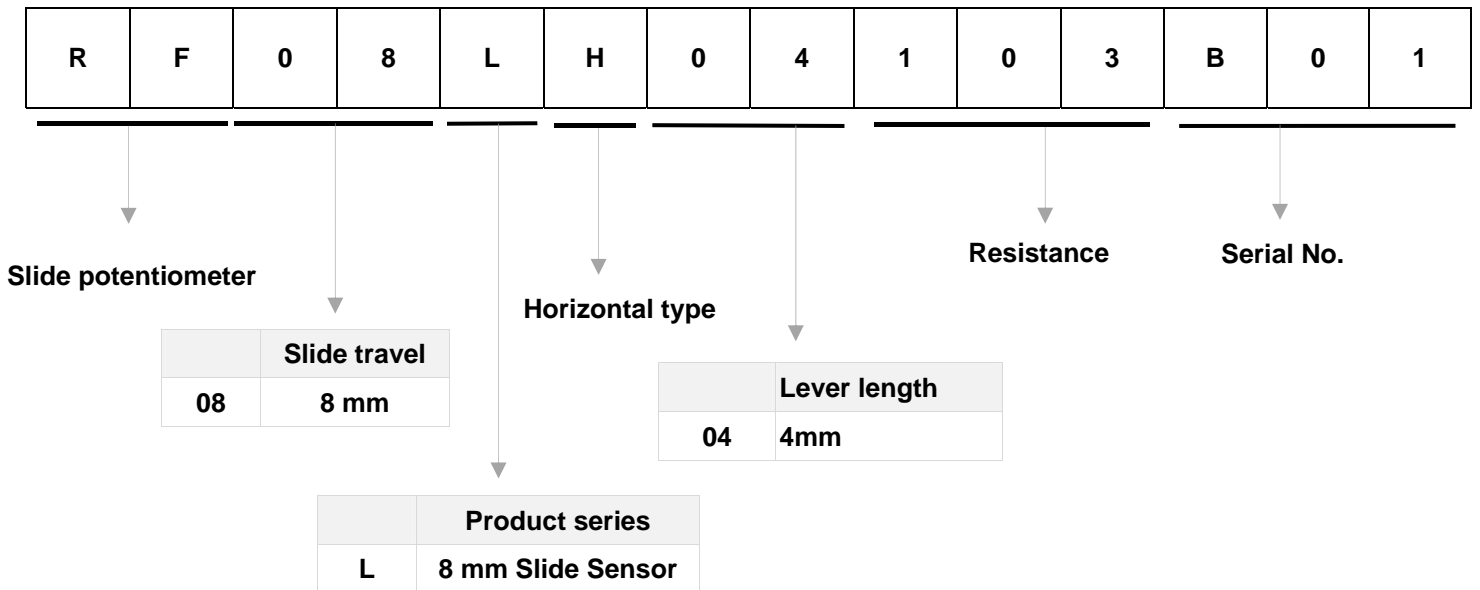

◆ COMMON SPECIFICATIONS

Characteristics	Specification
Operating temperature range	-40°C to +105°C
Operating force	120 gf MAX
Stopper strength	500gf / 3 sec
Lever push-pull strength	300gf / 3 sec
Solder heat resistance	Lower than 260°C for less than 5 seconds
Total resistance	3KΩ < Ra ≤ 30KΩ
Total resistance tolerance	±20%
taper	Linear
Linearity (absolute)	±3%
Insulation resistance	100MΩ min. 250V DC
Voltage proof	10 sec 250V AC
Sliding service life	100,000 cycles

SLIDE SENSOR

8 mm Slide Sensor

DIMENSIONS

Unit : mm

RF08LV

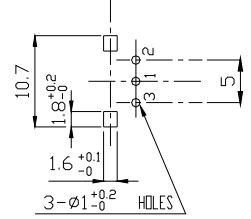
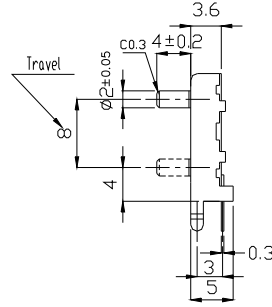
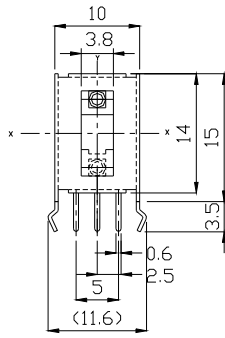

◆ POWER RATING CURVE :

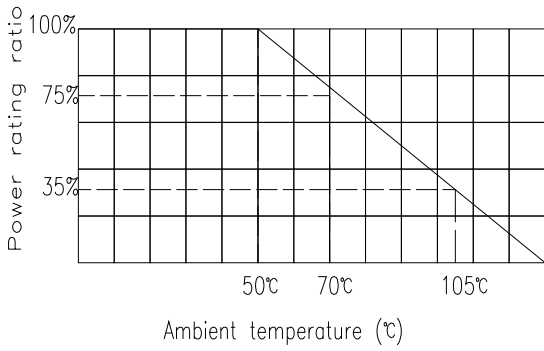

◆ REFERENCE CHARACTERISTIC CURVE

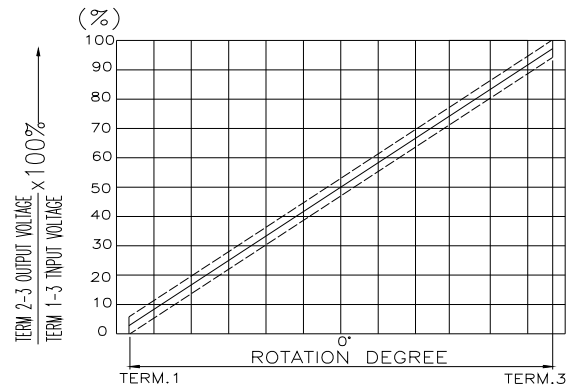

SLIDE SENSOR

Thin 45mm Magnetic Slide Sensor



◆ FEATURE

- Non-contact magnetic structure
- Extremely light feeling slide
- Thin and dustproof body design .
- Long life : 5,000,000 cycles

◆ APPLICATIONS

- Fader for mixer, professional audio equipment.

◆ PRODUCTS NUMBERING SYSTEM

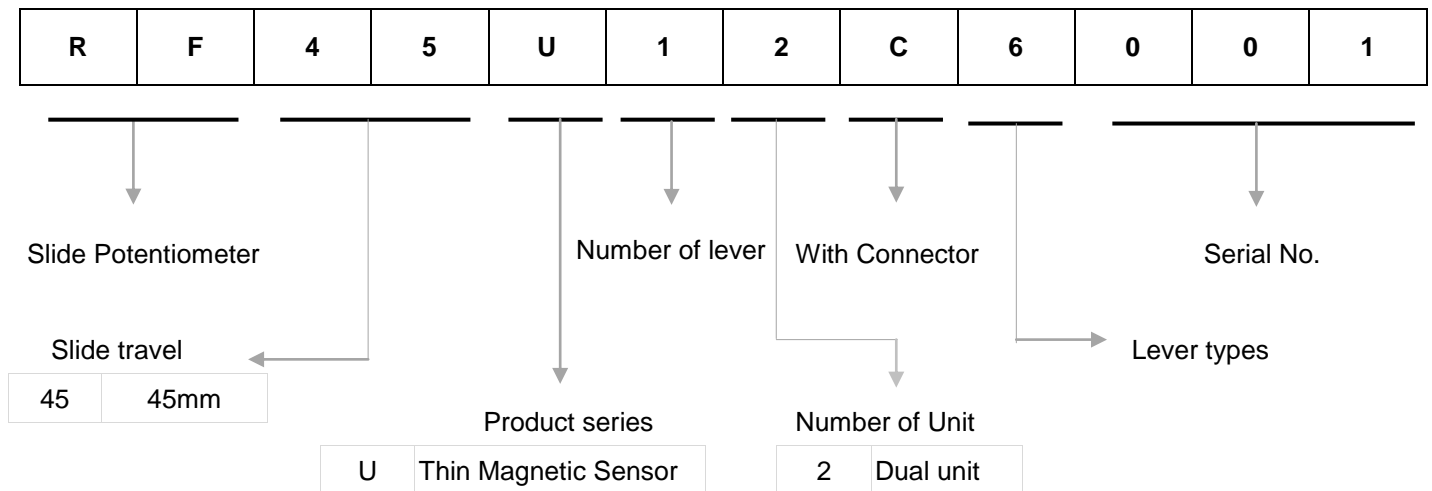

◆ COMMON SPECIFICATIONS

Characteristics	Specification
Operating temperature range	-10°C to +70°C
Input voltage	5V±3%
Output type	Voltage(absolute)
Output characteristic	X type (Refer from Position-Voltage plot below)
Output error	3%(MAX)
Stroke resolution	5 points/mm
Operating force	20 gf max
Sliding service life	5,000,000 cycles

SLIDE SENSOR

Thin 45mm Magnetic Slide Sensor

◆ LEVER TYPES

Material	Metal lever	
Lever type	6	9
	t=1.2	t=1.2
Dimensions		
Length (L)	15	8.2

DIMENSIONS

Unit : mm

Model	Dimensions
RF45U	 <p> V_{cc} Input G Ground F Output-F R Output-R </p> <p>CONNECTOR</p>

SLIDE SENSOR

45mm Magnetic Slide Sensor

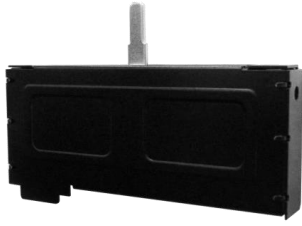

◆ FEATURE

- Non-contact magnetic structure
- Extremely light feeling slide.

◆ APPLICATIONS

- Fader for mixer , professional audio equipment.

◆ PRODUCTS NUMBERING SYSTEM

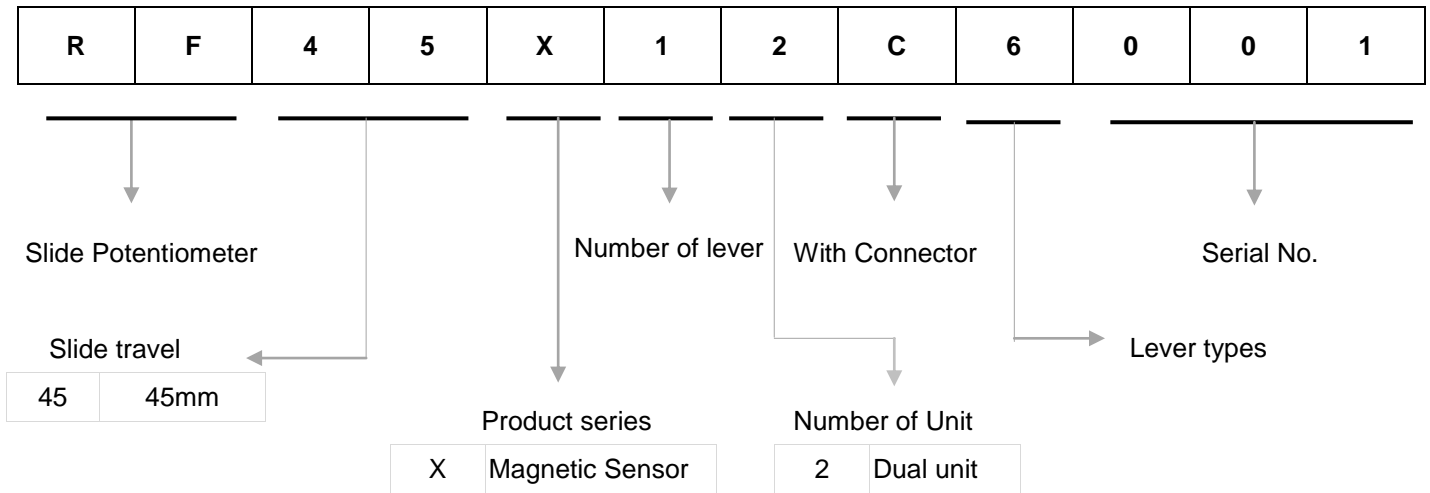

◆ COMMON SPECIFICATIONS

Characteristics	Specification
Operating temperature range	-10°C to +70°C
Input voltage	5V±3%
Output type	Voltage(absolute)
Output characteristic	X type (Refer from Position-Voltage plot below)
Output error	3%(MAX)
Stroke resolution	5 points/mm
Operating force	20 gf max
Sliding service life	4,000,000 cycles

SLIDE SENSOR

45mm Magnetic Slide Sensor

◆ LEVER TYPES

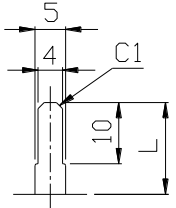
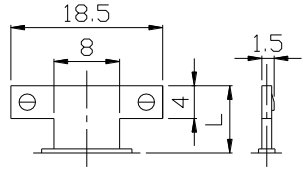
Material	Metal lever	
Lever type	6	9
	t=1.2	t=1.2
Dimensions		
Length (L)	11	15

DIMENSIONS

Unit : mm

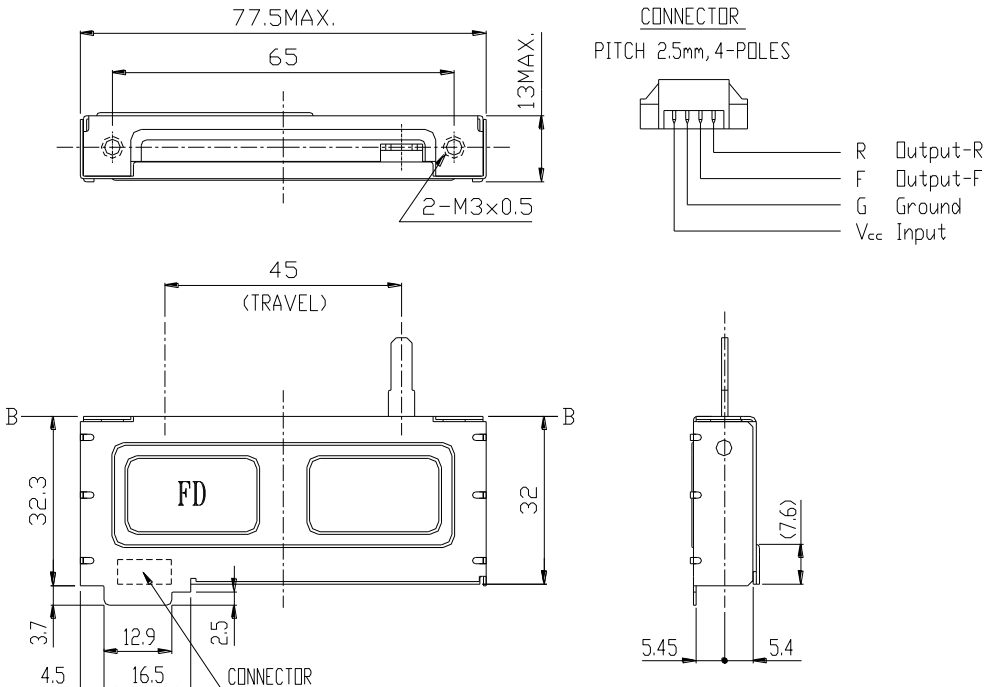
Model	Dimensions
RF45X	  <p>CONNECTOR PITCH 2.5mm, 4-POLES</p> <ul style="list-style-type: none"> R Output-R F Output-F G Ground V_{cc} Input