

Special Category Carbon Potentiometers

Type of special category carbon pots:

- Thin type pots – RD10
- 15mm Rotary Sensor
- Micro Pots – RK08

These will be further classified as :-

Horizontal/vertical mount, single/dual unit

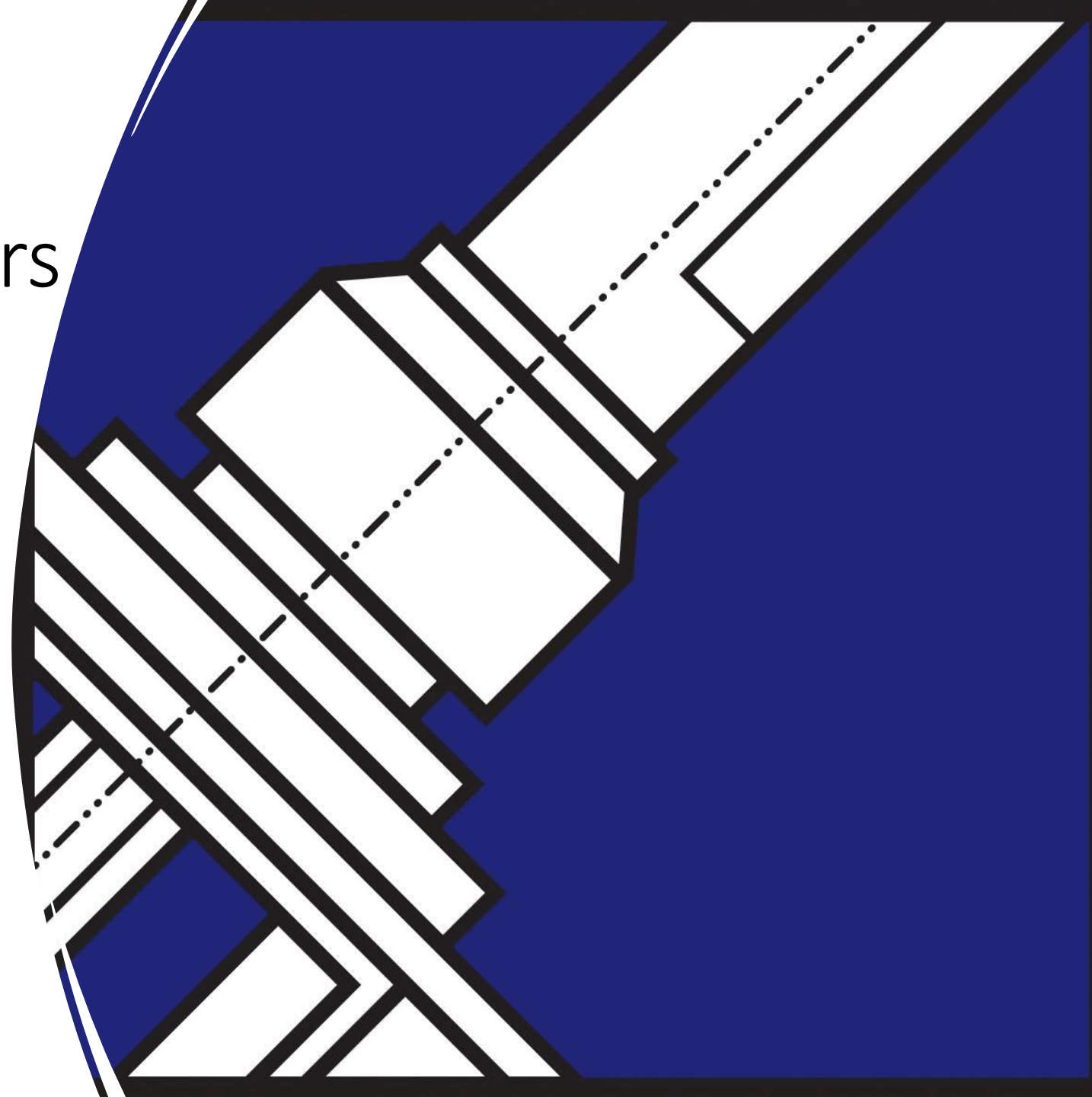

ROTARY POTENTIOMETERS

Thin Type Potentiometers

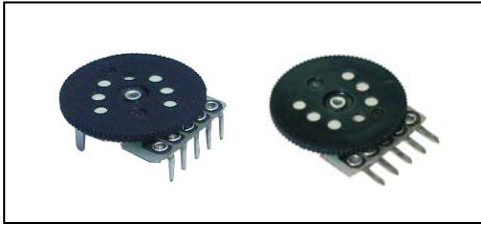

◆ Features

- Thin body, only 1.8mm in maximum thickness
- We offer both the DIP soldering type and reflow Type.

◆ Applications

- For volume controls, electronic tuning and brightness control in pocket radio , headphone stereo, Liquid crystal TV set, personal, CD-ROM, etc

◆ Common specifications

Applications	Single(Dual)-unit
Total rotational angle	270±10°
Rotational torque	5 to 100gf.cm
(KΩ)Total resistance(KΩ)	5,10,20,50,100
Total resistance tolerance (%)	±30
Power rating (W)	0.03
Max operating voltage	A.C.50V
Resistance taper	A, B, C, D,E(JIS)
Rotational life	10,000 cycles(R>5KΩ, 5,000 cycles)

◆ Products Numbering System

R	D	1	0	J	1	2	U	0	0	0	1
---	---	---	---	---	---	---	---	---	---	---	---

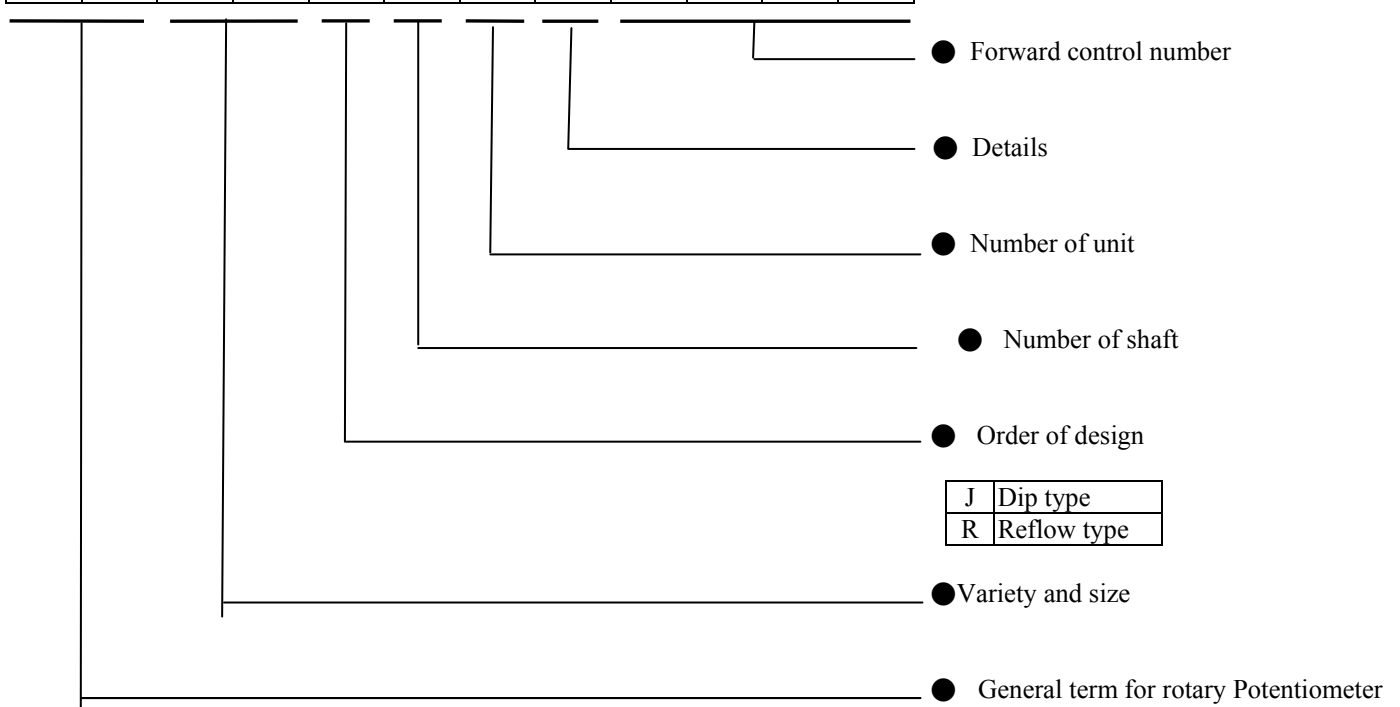

J	Dip type
R	Reflow type







RK	Old code
RD	New code

ROTARY POTENTIOMETERS

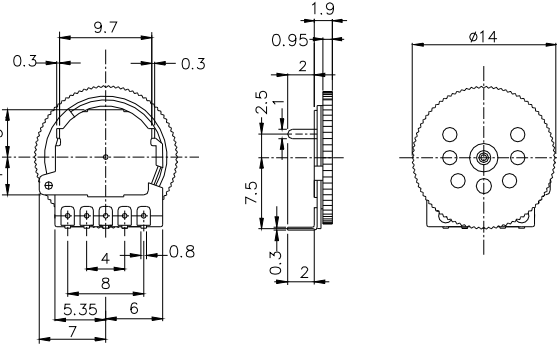
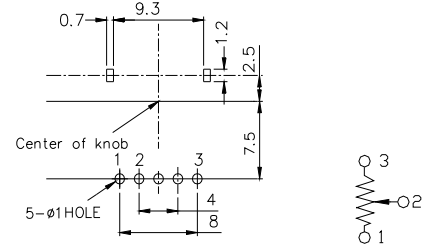
Thin Type Potentiometers

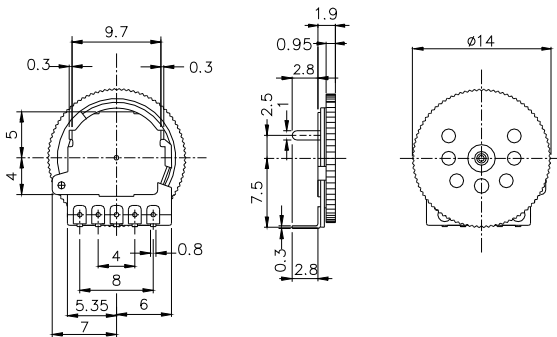
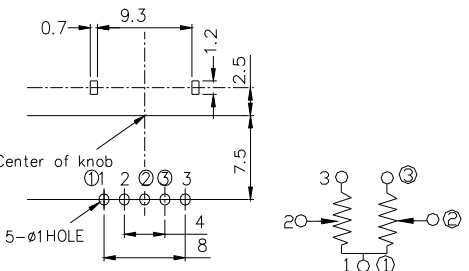
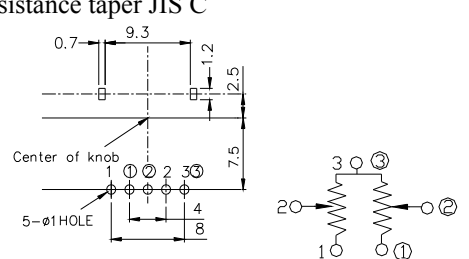
◆Dimensions

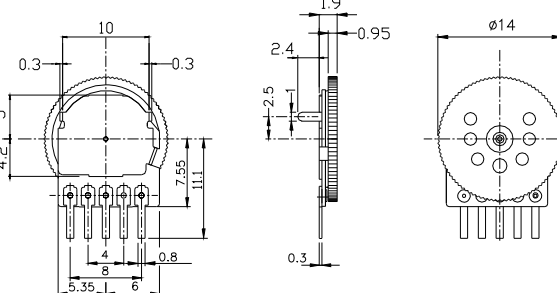
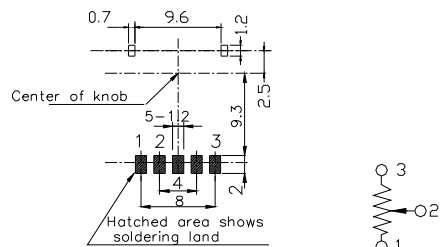
Unit: mm

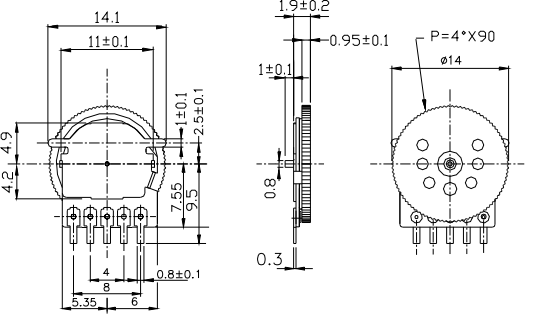
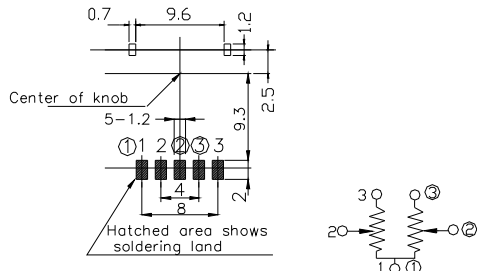
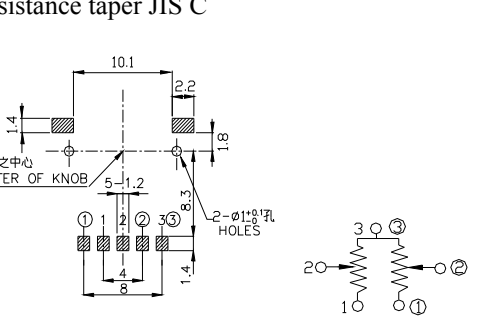
Model	Dimensions	Mounting hole details/ Circuit
	<p>M1</p> 	
	<p>M2</p> 	<p>Resistance taper A or B</p>  <p>Resistance taper JIS C</p> 
	<p>M1</p> 	
		<p>Resistance taper A or B</p>  <p>Resistance taper JIS C</p> 

ROTARY SENSORS

15mm Rotary Sensor



◆ Applications

- Automotive HVAC, Seat, Rear-view mirror actuator feedback sensor and HVAC Controls
- Timer & Function/ Programme and Select for washing machines, Dishwashers and all white Goods in general

◆ Feature

- Extend mechanical life
- SMD Reflow soldering capability
- Low profile, Linearity $\pm 3\%$ (standard)

◆ PRODUCTS NUMBERING SYSTEM

R	D	1	5	L	1	1	1	1	0	0	1
---	---	---	---	---	---	---	---	---	---	---	---

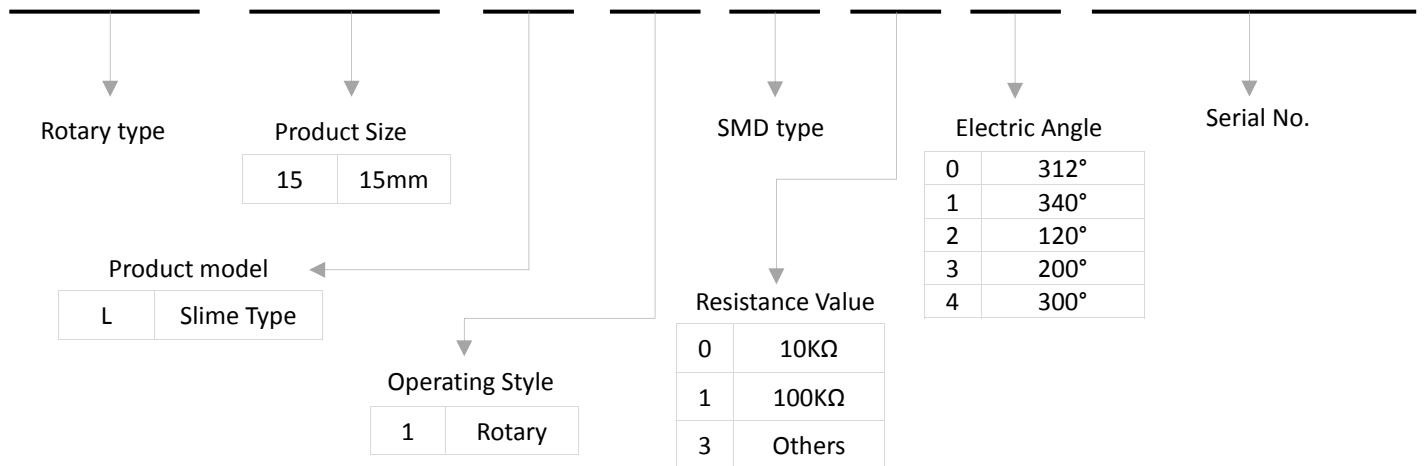

◆ COMMON SPECIFICATIONS

Characteristics	Specification
Total Resistance(Ω)	10K, 100K
Total Resistance Tolerance	$\pm 30\%$
Rated power (W)	0.15W @ 50°C
Linearity(absolute)	$\pm 3\%$
Taper	Linear
Mechanical Life(without load)	100,000 cycles
Operating temperature range(°C)	-40 ~ +85
Rotational Torque(gf-cm)	100 Max.
Max Voltage	DC 250V
Mechanical Angle	360° endless
Electrical Angle	340° $\pm 10^\circ$

ROTARY SENSORS

15mm Rotary Sensor

◆ POWER RATING CURVE :

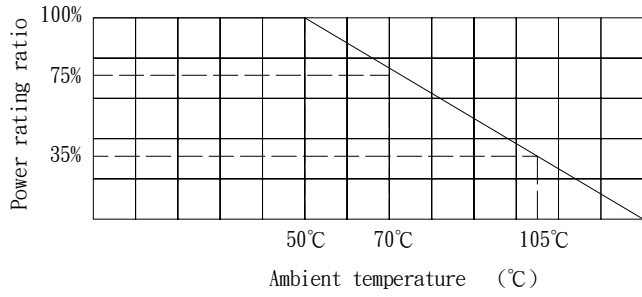

◆ REFERENCE CHARACTERISTIC CURVE

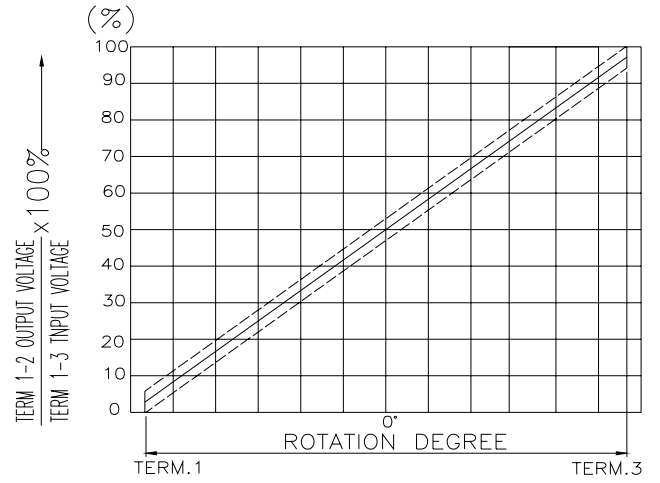

◆ DIMENSIONS

Unit : mm

RD15L111100N

SMD type

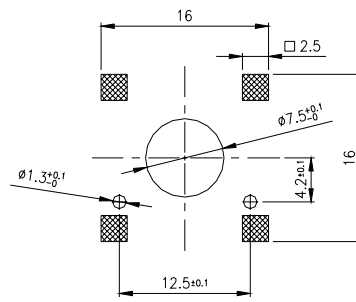
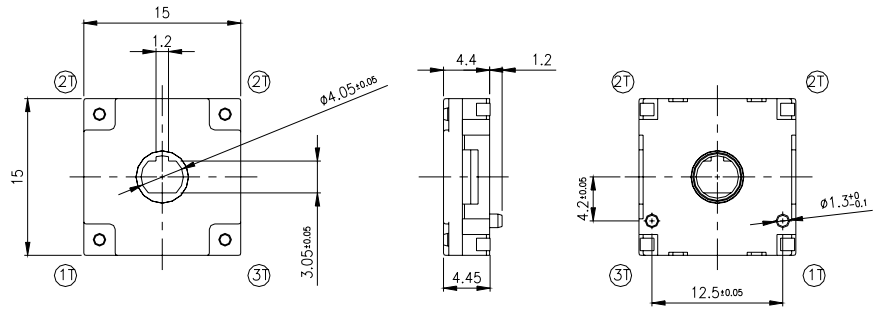

P.C.B TERMINAL POSITION

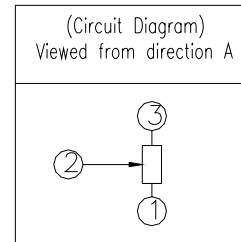

ROTARY POTENTIOMETERS

8mm Type Micro Potentiometers



◆ FEATURE

- For small ideal, low-profile sets.
- Dual-unit type offers superior gang error characteristics
- Single-unit control with detent and tap terminal available
- PC board thicknesses up to 1.6mm are available.

◆ APPLICATIONS

- For volume controls and tone controls in compact products such as radio, radio-cassette recorder, micro cassette recorder, compact TV sets and CD-ROM.
- For VCR tracking controls

◆ PRODUCTS NUMBERING SYSTEM

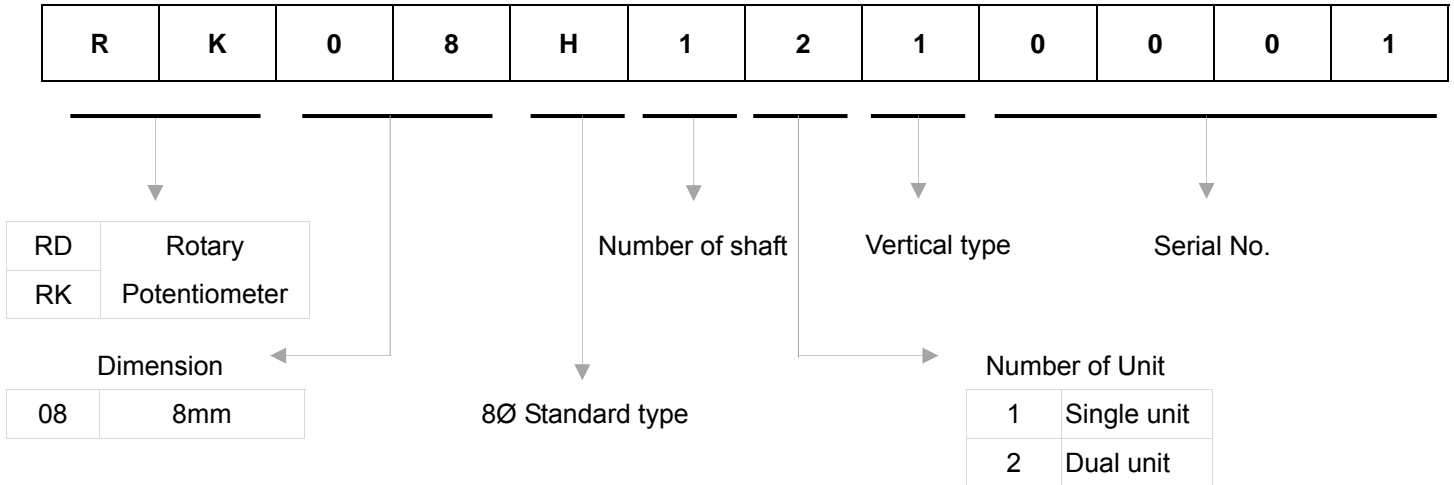

◆ COMMON SPECIFICATIONS

Application	8mm size	
	Single-unit	Dual-unit
Total resistance (KΩ)	5、10、20、50、100、250、500	
Total resistance Tolerance	±30%	
Resistance taper	A、B、C、D	
Power rating	0.03W	
Max operating Voltage	50V A.C	
Rotational angle	200±10°	
rating torque	10~100gf-cm	
Detent position	100±5°	-
Detent torque	10~100gf-cm	-
Rotational Life	10,000 cycles	10,000 cycles

ROTARY POTENTIOMETERS

8mm Type Micro Potentiometers

◆ STANDARD DIMENSION OF SHAFT AND PIN

Unit: mm

Shaft Dimension	Pin Dimensions

DIMENSION

Unit : mm

Model	Dimensions	Mounting hole details / Circuit
Single-unit RK08H111 		Single-unit
Dual-unit RK08H121 		Dual-unit Taper A · B · D
		Dual-unit Taper C